

# FLOOR SUPPORT FOR i3HAWM

i3-learning offers a broad range of linear motion solutions that help move your application in any direction: horizontal, vertical and diagonal. Challenge us, in any way. Based on its 180 years' experience in linear motion solutions, i3-learning offers a range of high quality products for use with large touchscreen displays and interactive whiteboard systems. In our challenge to offer you a comfortable and intuitive solution to adjust your screen vertically, we have developed the i3HAWM, a user-friendly, ergonomic, high-quality, reliable and sustainable product that allows you to move your screen up and down, in a manual way.

**Included:**

- Fasteners for i3HAWMm LCD66, i3HAWMm LCD90 & i3HAWMm IWB
- Cover strips for legs

**Not included:**

- Fasteners for wall mounting

Floor support frame		
Lenght	2012mm	46.5 inch
Width	420mm	57.4 inch
Depth	45 mm	5.6 inch
Load capacity	125 kg	209 lbs
Material	Sheet steel frame	
Finish	Powder coated in colour: White RAL9010	

Shipping dimensions		
Lenght	1020mm	40.1 inch
Width	127mm	5 inch
Depth	75mm	3 inch

The i3HAWMm is the perfect solution to move your touchscreen or interactive whiteboard manual up and down. i3HAWMm LCD 66 and i3HAWMm LCD 90 are manufactured of compact and stylish stainless steel design that is hidden behind the screen, and offers the user a vertical travel range of 400 mm (15.75 inch).

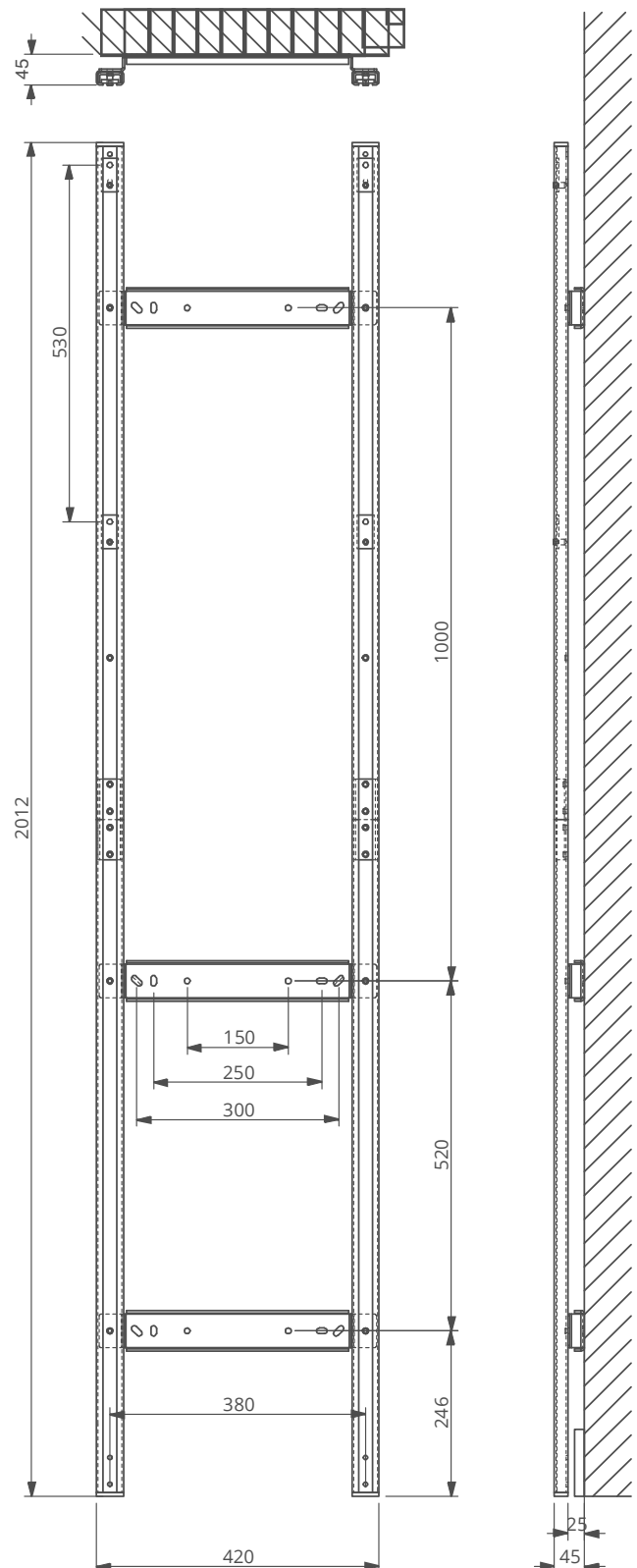

**AUTHORISED DISTRIBUTOR**